

# LOOMI™ HOLIDAYS

MAKING SEASONS BRIGHTER

## SAFETY GUIDELINES

**WARNING: PLEASE READ AND UNDERSTAND ALL INSTRUCTIONS THOROUGHLY BEFORE USE.** Not adhering to all instructions provided below can lead to severe personal injury, fire, and/or electric shock.

### WARNING: ELECTRICAL PRODUCT.

Keep out of reach of children. To reduce the risk of electric shock, take precautions while handling and using electrical products. To prevent potential hazards, a damaged power cord should only be replaced by the manufacturer, its authorized service agent, or an expert with similar qualifications. To prevent the danger of electric shock, make sure to disconnect the product from the electrical outlet before attempting any assembly, disassembly, or relocating. Only adults should assemble this product.

### IMPORTANT SAFETY INSTRUCTIONS.

BEFORE USING THIS PRODUCT, READ AND ADHERE TO ALL PRECAUTIONS AND SAFETY INSTRUCTIONS, INCLUDING:

- This product should not be treated as a toy but as an electrical device. To prevent the possibility of fire, electric shock, or personal injury, keep this product out of reach of children.
- Using seasonal products outdoors is prohibited unless they are labeled as appropriate for both indoor and outdoor use. For outdoor applications, it is important to connect the product to a Ground Fault Circuit Interrupting (GFCI) outlet. If a GFCI outlet is not present, it is advisable to contact a certified electrician to ensure proper installation.
- This seasonal product is designed for temporary use and is not intended for permanent installation or long-term usage.
- Before leaving the house, going to bed, or leaving the product unattended, remember to unplug it.
- To prevent damage to the product wiring, do not use staples or nails to secure it. Refrain from placing it on sharp hooks or nails.
- Avoid mounting or placing near gas or electric heaters, fireplaces, candles, or any other sources of heat.
- Avoid closing doors or windows on the power cord as doing so can damage the wire insulation.
- Avoid hanging ornaments or any other objects from the power cord, tethers, or LED light string.
- Avoid using this product for purposes other than its intended use.
- Avoid covering the product with cloth, paper, or any material that is not part of the product while it is in use.
- Avoid placing the product against carpeting, furniture, or any other fabric while it is in use.
- One of the features of this product is a polarized plug, where one blade is wider than the other to minimize the risk of electric shock. The plug of this product can only be inserted into a polarized outlet in one direction. If the plug does not fit securely into the outlet, try reversing the plug. Contact a qualified electrician if the plug still does not fit.
- Avoid using an extension cord if the plug cannot be fully inserted. It is important not to modify or substitute the plug.
- Always carefully read and adhere to all instructions included with the product.

### PLEASE RETAIN THESE INSTRUCTIONS FOR FUTURE REFERENCE.

### INSTRUCTIONS FOR USE AND MAINTENANCE:

1. Inspect the product carefully before each use or reuse. Dispose of any products that have cut, damaged, or frayed power cords, tears, and/or loose connections.
2. To prevent strain or stress on the product conductors, connections, and wires, carefully remove the product from trees, branches, or bushes when storing it.
3. Store the product in a cool and dry place away from sunlight when not in use.

### For increased safety, take the following precautions:

1. Avoid installing the product on trees that have needles, leaves, or branch coverings made of or metal-like materials to reduce the risk of fire and electric shock.
2. Avoid mounting or supporting the power cords in a way that could potentially cut or damage it.

**CAUTION:** In case of unusually strong winds, do not try to inflate this unit. If the weather conditions are not safe for operation, let the unit deflate and wait for safer conditions before inflating.

**CAUTION:** Avoid connecting this product with another electrical product. To minimize the risk of electric shock, avoid direct exposure of the electric fan and power cord to water. If the temperature drops below 14°F (-10°C), the motor may stop running temporarily. The motor will resume normal operation once the temperature rises.

### WARNING

Remove and dispose of all plastic fasteners and tags as they are only used for packaging purposes. Please do not use this item as a toy. It is intended for decorative purposes only.

This product is suitable for both indoor and outdoor use and operates at 120V with a frequency of 60Hz.

### CAUTION:

For temporary installation and use up to a maximum of 90 days only.

### TROUBLESHOOTING

If your inflatable is not inflating, it could be due to:

1. The power source may be disabled or the cord may be unplugged.
2. There may be an obstruction in the motor.
3. The temperature might be lower than 14°F (-10°C).
4. The zipper may not be properly closed, preventing the inflatable from being sealed.

**NOTE:** When the fan is unplugged and stops blowing, the inflatable will deflate.

### WARNING:

This device complies with Part 15 of the FCC Rules. Operation is subject to the following two conditions: (1) this device may not cause harmful interference, and (2) this device must accept any interference received, including interference that may cause undesired operation.

## INSTRUCTIONS FOR ASSEMBLY

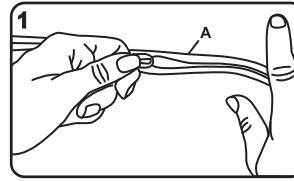

Make sure that there are no obstructions blocking the air intake, and ensure that all zippers are fully closed. Some inflatables may have more than one zipper.

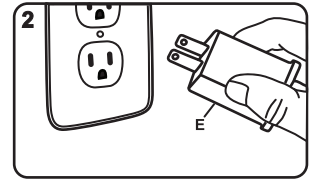

Insert the power supply (E) into the fan and plug it into a standard wall outlet.

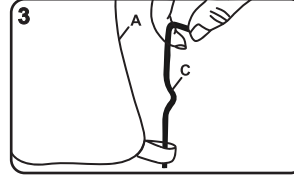

Insert stakes (C) into the ground through ground loops on inflatable. Adjust the water/sand bag to position the inflatable.

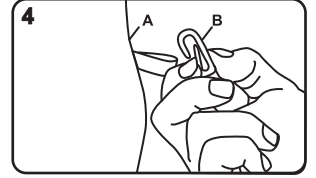

Secure the tethers (B) to the side webbing loops (A) once the inflatable is fully inflated.

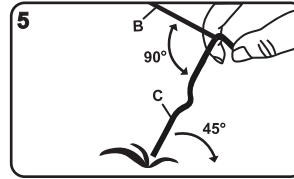

Tie each tether to a stake (C) and insert the stakes (C) into the ground at a 45-degree angle.

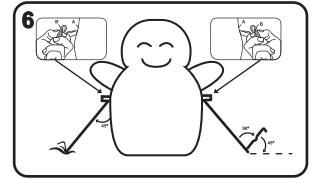

Secure tethers to the ground at a 45-degree angle to the inflatable and wrap excess tethers around top of the stake.

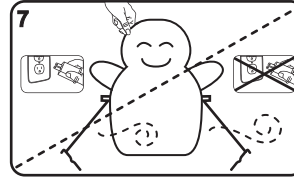

### Best Practices and Precautions

1. Check your inflatable daily and make any necessary adjustments to ensure it is standing upright.
2. Avoid operating your inflatable during strong winds.
3. Do not unplug by pulling the cord.

### ITEMS INCLUDED IN THE PACKAGE

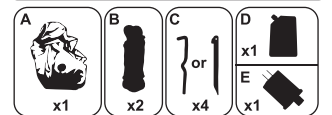

Part	Description	Qty
A	Inflatable	1
B	Tethers	2
C	Stakes	4
D	Water/sand bag	1
E	UL Listed power supply Input: 120V-150VAC - 50/60Hz Output: 12V=1.0A	1

### FREQUENTLY ASKED QUESTIONS (FAQs)

#### 1. What can I do if my inflatable is torn?

You can mend the punctures in the inflatable either by stitching them up by hand (special threads not required) or by using clear packing tape to patch them up.

#### 2. Is it safe to run my inflatable continuously?

Your inflatable can run continuously during the day and at night. However, we recommend that you turn it off when leaving the immediate area, when going to bed at night, or when conditions are not safe.

#### 3. Why does my inflatable deflate when I disconnect it from the power source?

Your inflatable can only remain inflated if it is connected to the power source and the fan is actively circulating air.

#### 4. How can I clean my inflatable?

You can clean it by wiping with a moistened cloth and letting it dry before storing it. If necessary, use a mild detergent.

#### 5. How much electricity does my inflatable consume?

The energy it utilizes is approximately the same as that consumed by a standard set of holiday lights.

#### 6. After storing my inflatable for several months, why is the motor not functioning?

Occasionally, loose grass, leaves, or other debris may block the air intake. Try gently shaking, knocking, or tapping the motor to see if it will start running again.

#### 7. What is the optimal method for storing my inflatable?

Place it in a bag, box, or any suitable storage container and store in a cool, dry place away from sunlight.

For more information, visit [www.loomiholidays.com](http://www.loomiholidays.com)

©2023 Loomi Holidays, Inc. All Rights Reserved.

437 N VINCENT AVE, COVINA CA 91722-3907 U.S.A.

1 (866) 714 - 2531

MADE IN CHINA / PRINTED IN CHINA